

# WELCOME

Thank you for coming to the Public Open House.

The City of Pitt Meadows is developing an Expansion Plan for Pitt Meadows Athletic Park.

The expansion plan is spurred by the City's recent acquisition of the Amenity Lands site, an eight acre parcel of land adjacent to the existing park. The expansion plan proposes to introduce new sports and support facilities to the site as well as integrate this area into the existing park. The plan is intended to ensure the expanded Pitt Meadows Athletic Park continues to meet the active recreational needs of the community.

As part of the planning process, the City would like to consult with you, show you the proposed Pitt Meadows Athletic Park Expansion Plan and hear your thoughts and ideas about the project.

Please review the display boards, and share your comments and ideas. We will use your input to develop the final Pitt Meadows Athletic Park Expansion Plan.



## GOALS FOR TODAY

1. Introduce the Pitt Meadows Athletic Park Expansion project
2. Outline design goals for the project
3. Review the proposed park expansion plan

## Questions?

Please speak to staff from the City of Pitt Meadows and ISL (the consulting park planners).

## BACKGROUND

The Pitt Meadows Athletic Park is the city's only dedicated sports park. The 27 acre site contains five regular and two mini soccer fields, eight baseball/softball diamonds, as well as tennis, pickle ball, and sport courts. The park can accommodate seating for 320 and parking for 344 vehicles. In 2021, the City acquired an eight acre parcel of land to the immediate west of the existing park with the intention of expanding the Pitt Meadows Athletic Park into this site.

### 2021 PITT MEADOWS PARKS, RECREATION AND CULTURE MASTER PLAN



In 2021, the City of Pitt Meadows adopted the Pitt Meadows Parks, Recreation and Culture (PRC) Master Plan, a comprehensive document designed to guide the development and enhancement of the city's parks, recreation, and culture amenities.

The PRC Master Plan makes several recommendations regarding Pitt Meadows Athletic Park:

- Develop Pitt Meadows Athletic Park as a hub site for outdoor sports in the city
- Consolidate ball diamonds at the Pitt Meadows Athletic Park
- Develop a covered multi-use sports box
- Enhance support amenities including spectator seating, field lighting, covered area, storage and parking

The PRC Master Plan would transform Pitt Meadows Athletic Park into a city-wide athletic park. The Master Plan identifies a city-wide athletic park having the following amenities:

- Eight or more playing field surfaces
- Premium grass and/or artificial turf playing fields
- Field house/ concession/ washroom building
- Spectator seating
- Located with other major sport and recreation infrastructure

The Pitt Meadows Athletic Park Expansion Plan proposes the introduction of the recommended sports and support facilities to the park to convert it into a city-wide athletic park.

### WHAT WE HEARD

In 2023, the City gathered input from the community regarding Pitt Meadows Athletic Park and the newly acquired Amenity Lands adjacent to the park through Have Your Say Pitt Meadows. The graph below shows the community support for additional park features. Field lighting, covered multi-sport box, running track, and picnic shelter received the most support.

The proposed Pitt Meadows Athletic Park Expansion Plan was informed by these community priorities.

Which park improvements would be important to you in the current park space and additional 8 acres of Amenity Lands?

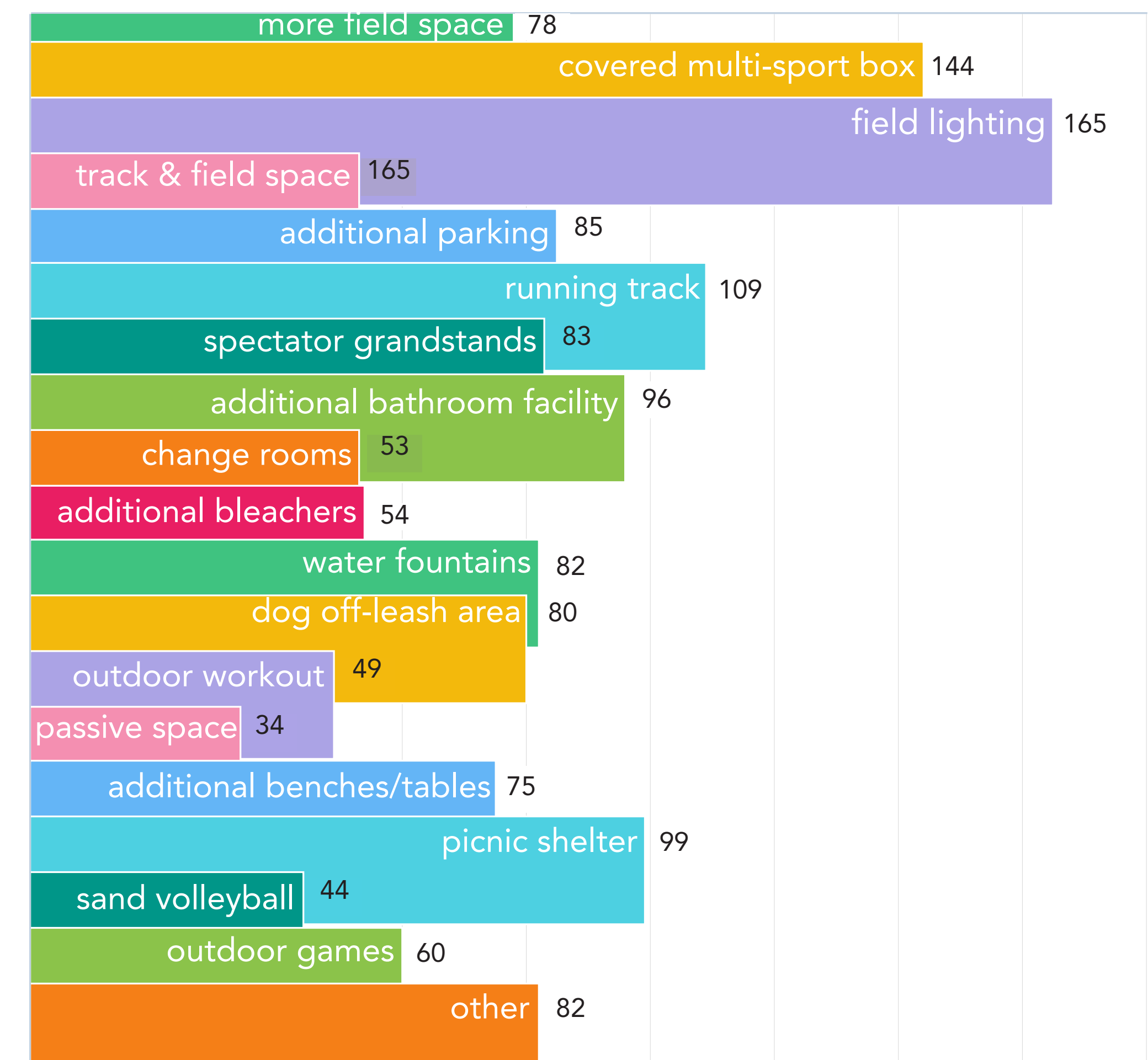

# SITE ASSESSMENT



## GENERAL ISSUES

- Limited parking space for expanded park use
- Lack of park amenities such as benches and picnic shelters
- Lack of park lighting
- Lack of spectator seating
- Lack of shade tree cover

Existing multi-use pathway to be retained

Existing ball field is undersized

Existing ball field has poor orientation

Golden Ears Business Park

Adjacent site for park expansion

Amenity Land Site

Pitt Meadows Arena Complex

Poor pedestrian access between the existing park hub and arena

Potential site for additional parking

Existing playground -flyball issue from adjacent ball field

Existing park hub

Existing field house

Lack of connection between Amenity Land Site and the existing park

Poor access to and no parking facilities close to this ball field



## PROPOSED PLAN

### PLANNING RATIONALE

The Pitt Meadows Athletic Park Expansion Plan responds to the recommendations made in the 2021 Pitt Meadows Parks, Recreation and Culture Master Plan, input from community engagement and issues identified in the site assessment.

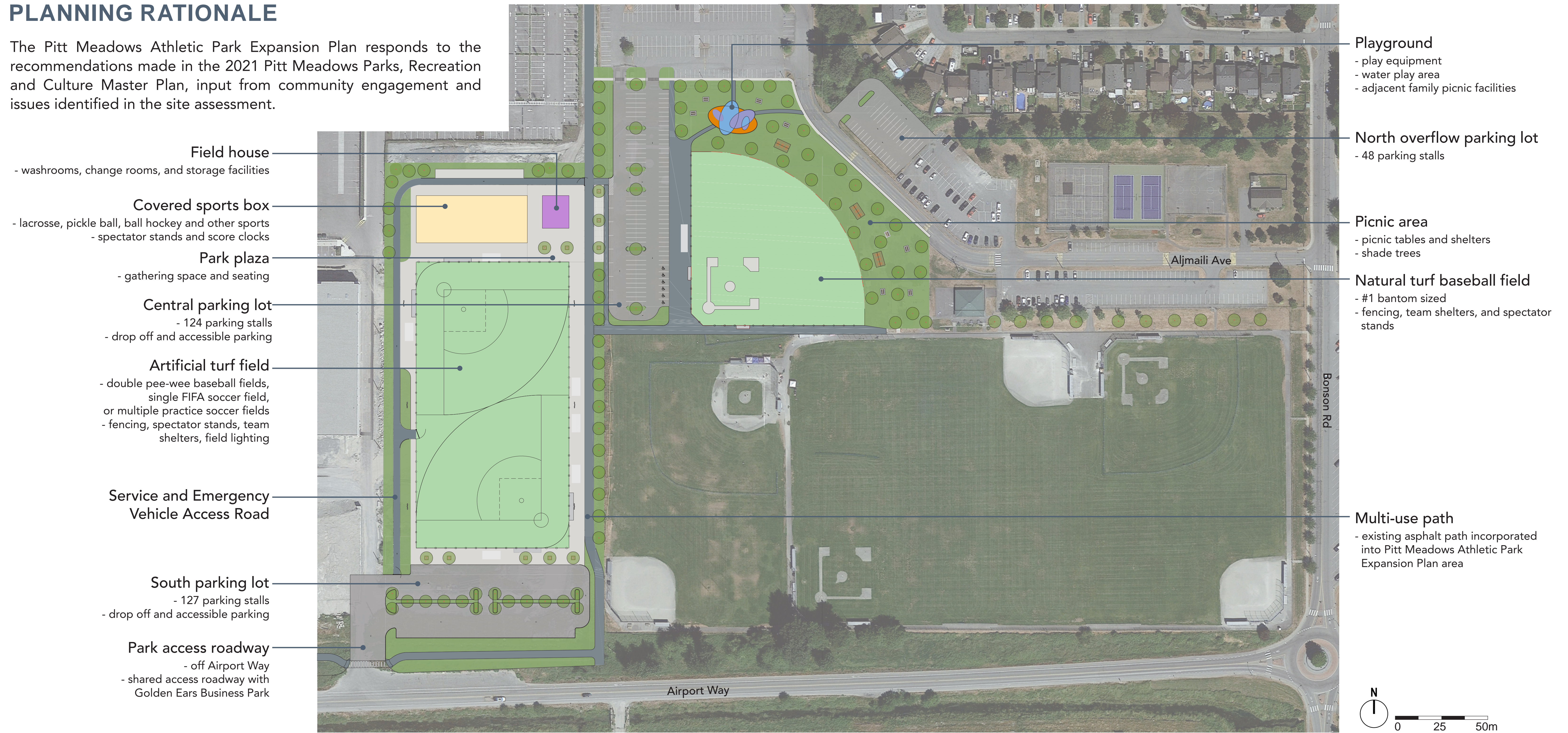

# PROPOSED PLAN PERSPECTIVE IMAGES

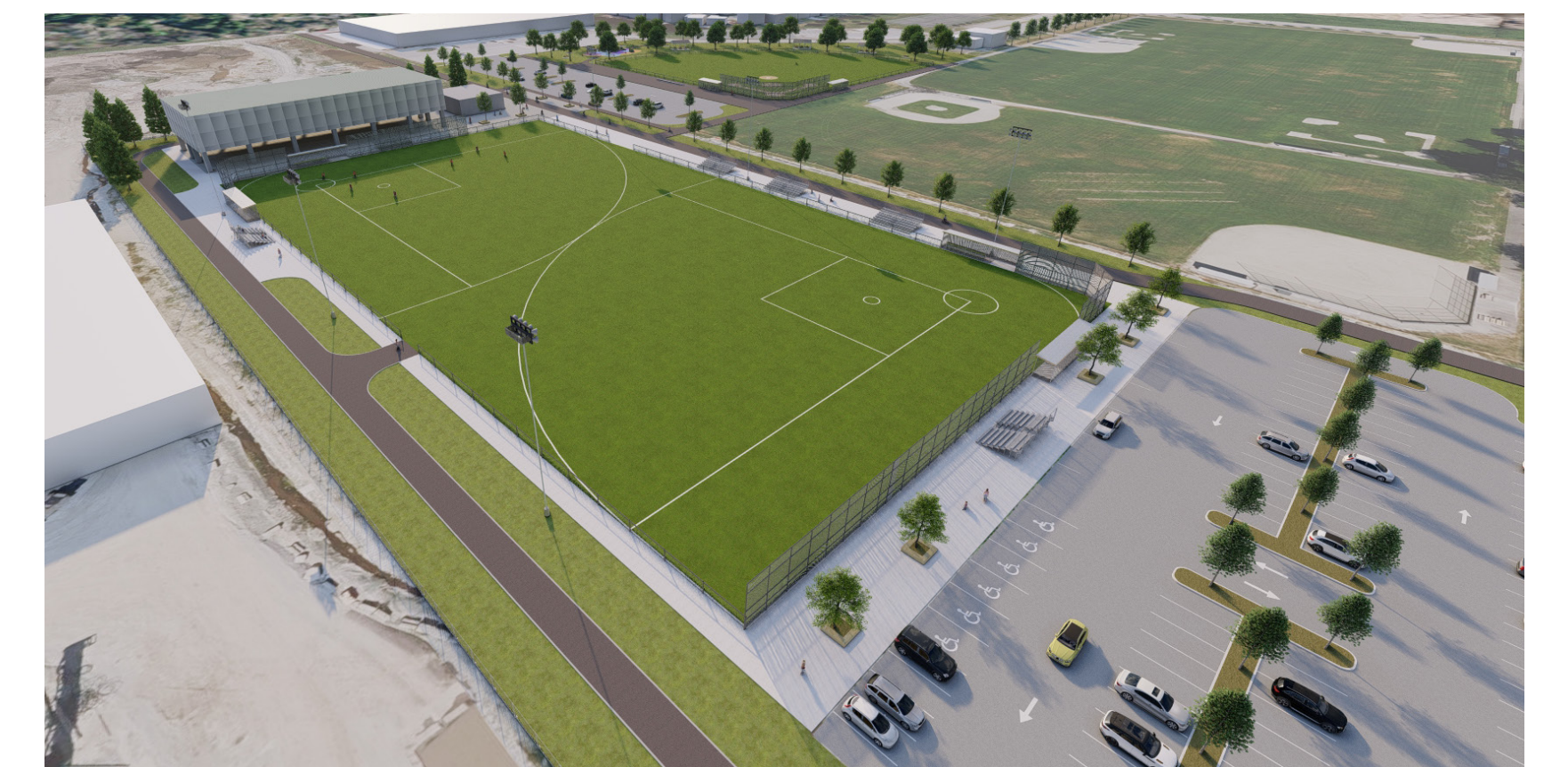
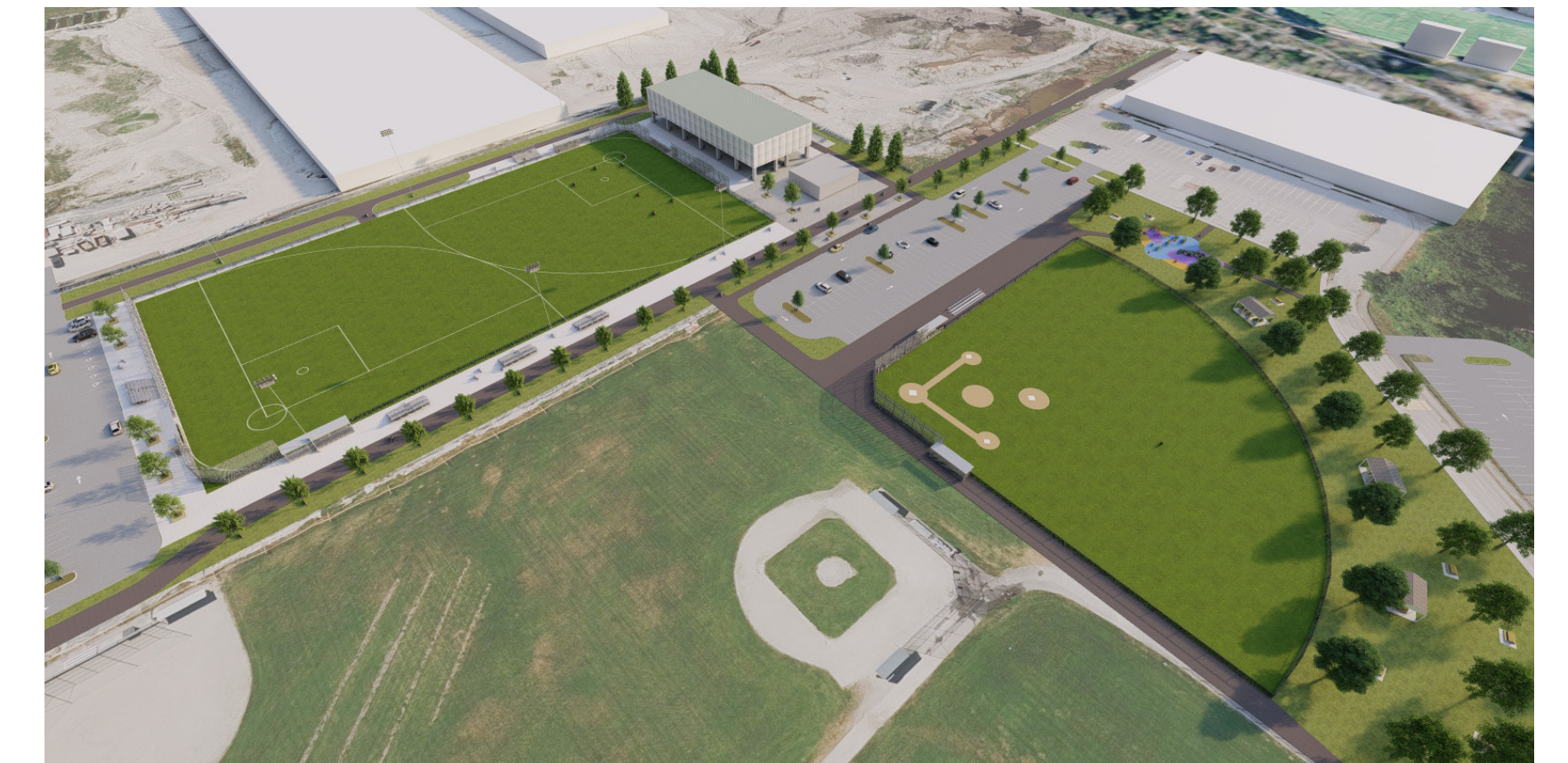

# YOUR FEEDBACK

What do you like about the proposed plan?

What is missing in the proposed plan?

Do you have any concerns about the proposed plan?

Empty response area for feedback on what is liked about the proposed plan.

Empty response area for feedback on what is missing in the proposed plan.

Empty response area for feedback on concerns about the proposed plan.

# YOUR FEEDBACK

Please share any issues with the existing park that we haven't considered in our site assessment.

Instructions: Use a Post-It Note to share your concerns.



## NEXT STEPS & TIMELINE



Thank you for coming! We want to hear from you. Please fill out our comment form tonight and return it to us on your way out, or fill out the survey online!

Don't miss out and take the online survey by **November 2, 2023.**

[www.haveyoursaypittmeadows.ca/parkplans](http://www.haveyoursaypittmeadows.ca/parkplans)



SCAN ME

### Stay Informed

Learn more and visit [www.pittmeadows.ca/parksprojects](http://www.pittmeadows.ca/parksprojects)