

**HARRIS ROAD COMPLETE STREET FEASIBILITY STUDY**  
**OPTION 2 - SEGMENT 1 & 2 (FRASER WAY TO FIELDSTONE WALK)**  
**OCTOBER 2025**  
**SHEET 01 OF 03**

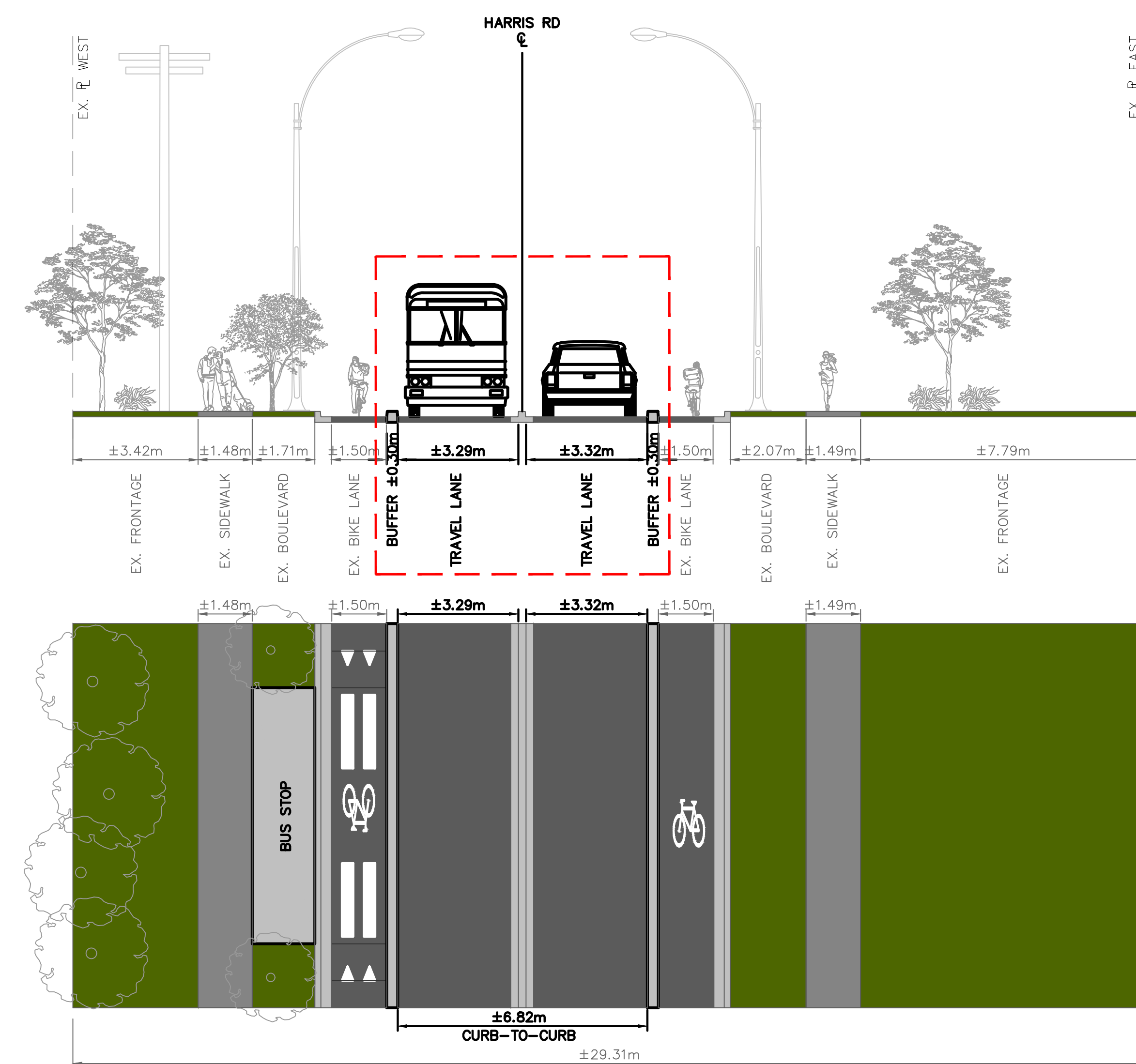

**HARRIS ROAD SEGMENT 1 (FRASER WAY TO AIRPORT WAY)**  
**TYPICAL CROSS SECTION**


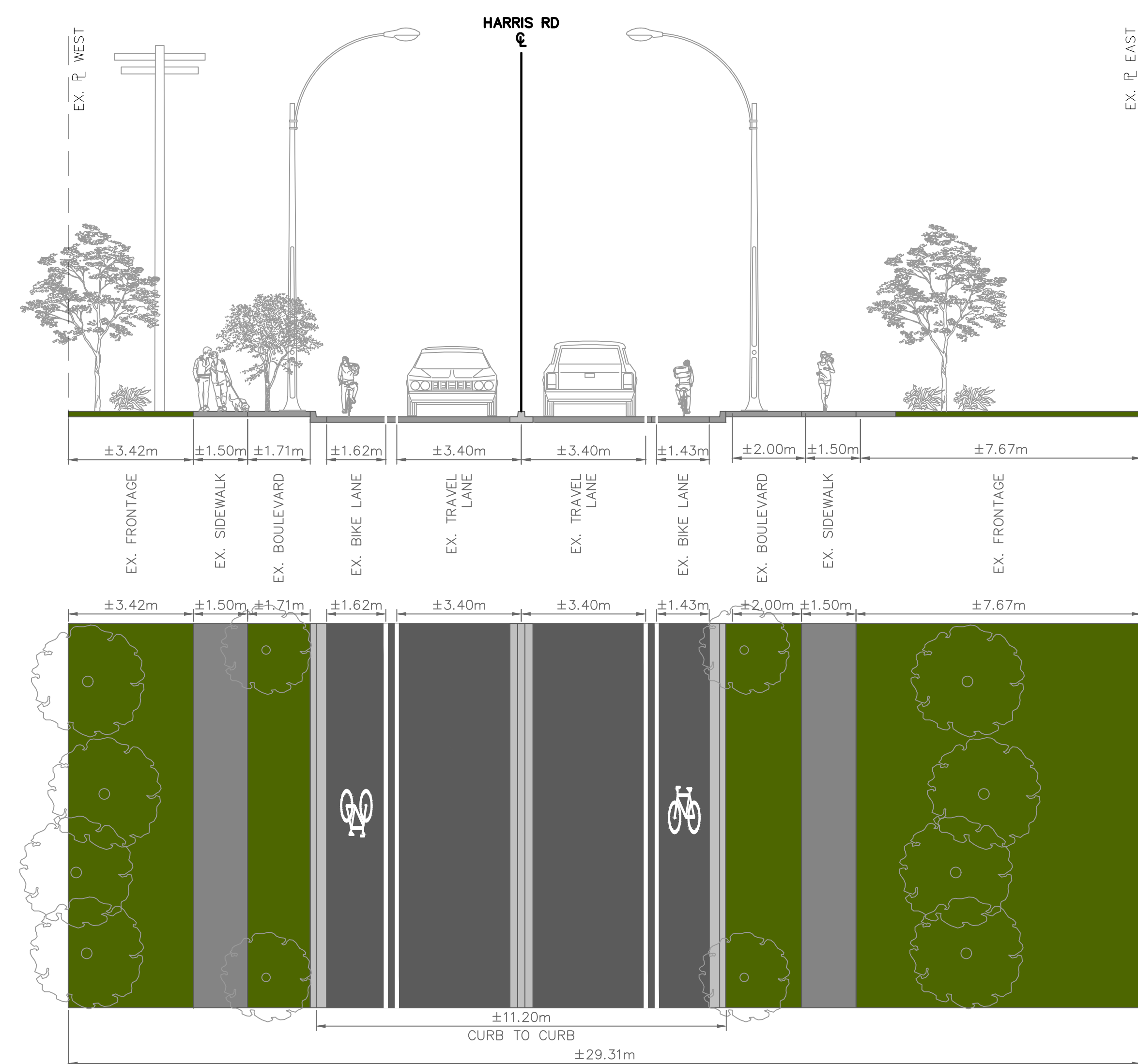

**EXISTING HARRIS ROAD SEGMENT 1 (FRASER WAY TO AIRPORT WAY)**  
**TYPICAL CROSS SECTION A**

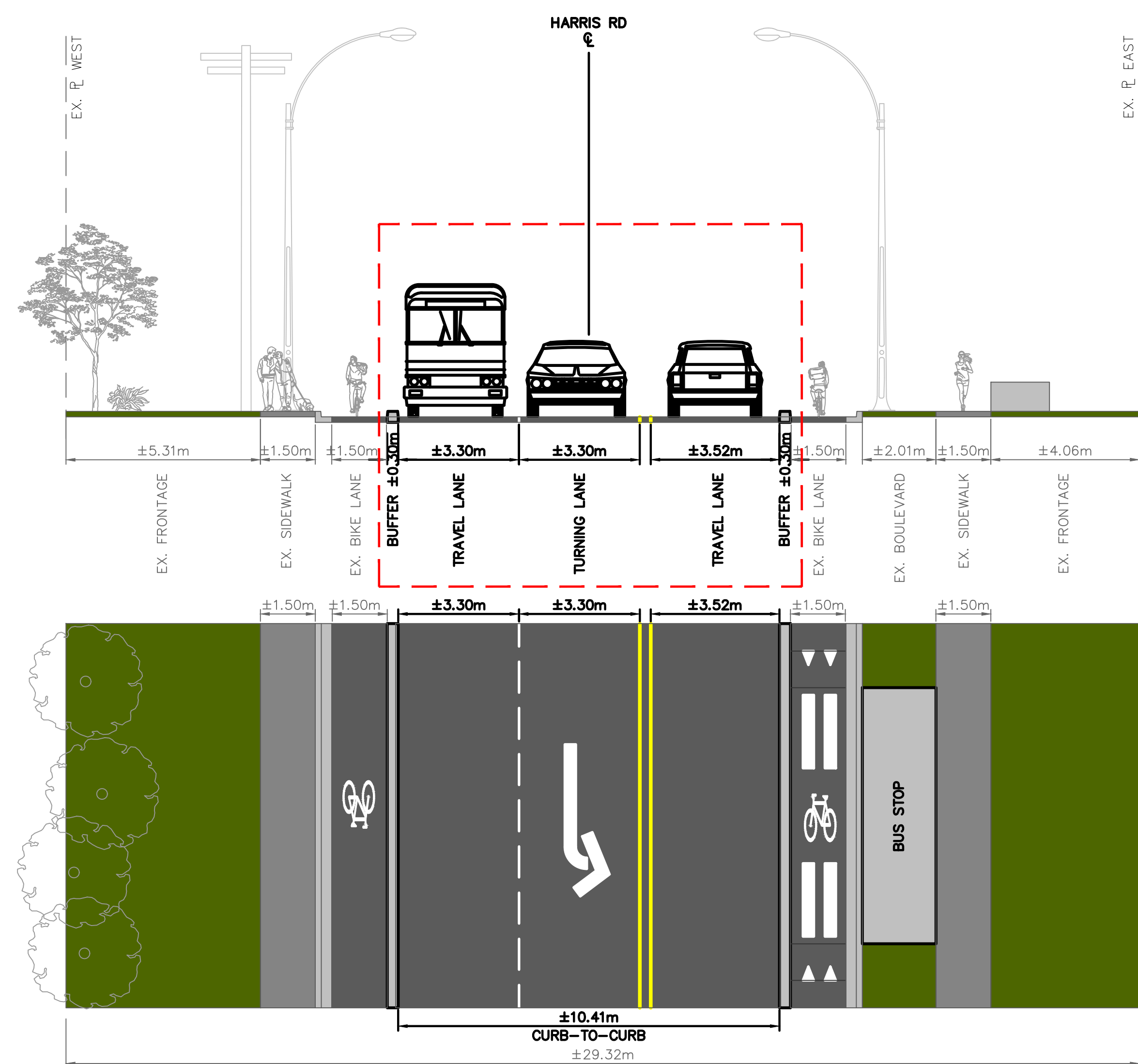

**HARRIS ROAD SEGMENT 2 (AIRPORT WAY TO FIELDSTONE WALK)**  
**TYPICAL CROSS SECTION**

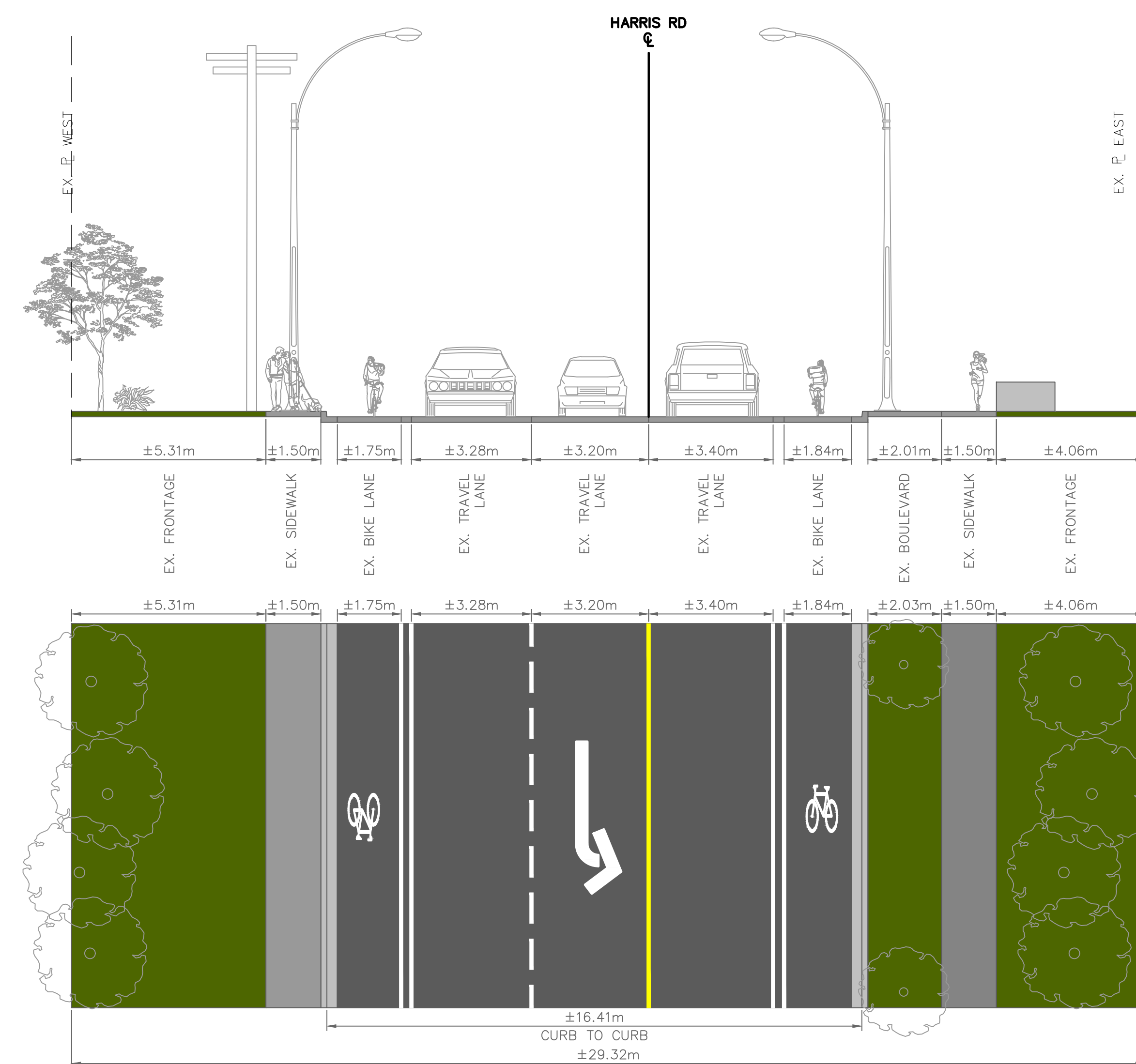

**EXISTING HARRIS ROAD SEGMENT 2 (AIRPORT WAY TO FIELDSTONE WALK)**  
**TYPICAL CROSS SECTION B**

**LEGEND**

- CONCRETE SIDEWALK
- ASPAHLT
- ASPAHLT MULTI-USE PATHWAY
- LANDSCAPING / GRASS
- DRIVEWAY
- EXISTING STREETLIGHT
- PROPOSED STREETLIGHT
- TRAFFIC SIGNAL
- EXISTING UTILITY BOX / POLE AND TRAFFIC POLE TO BE RELOCATED
- EXISTING TREE REMOVAL
- PROPOSED TREE
- FUTURE TRANSIT STOP
- EXISTING TRANSIT STOP
- PROPOSED DESIGN AREA



SEGMENT 2 | SEGMENT 3

SEGMENT 3 | SEGMENT 4

SEGMENT 4 |

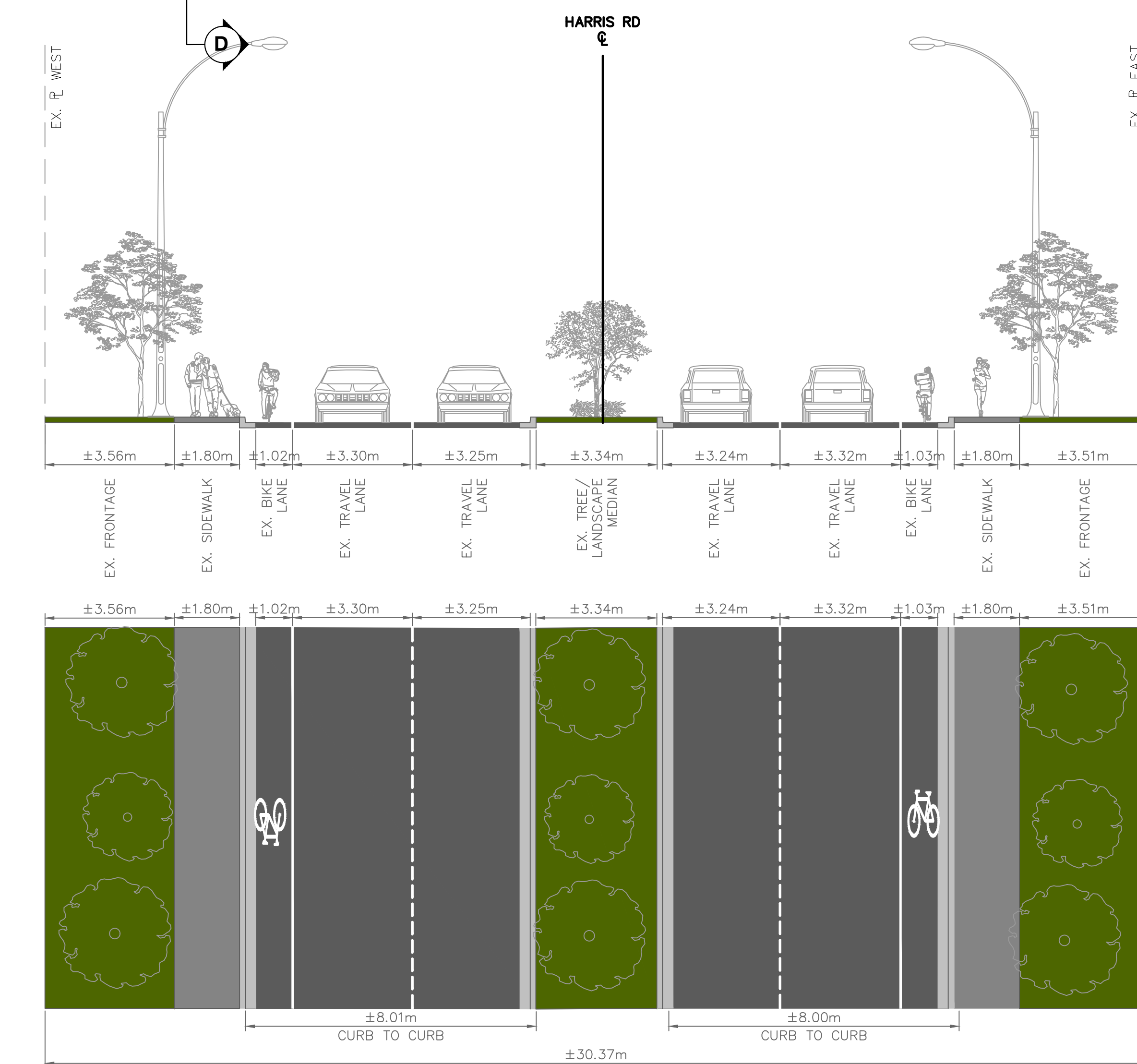
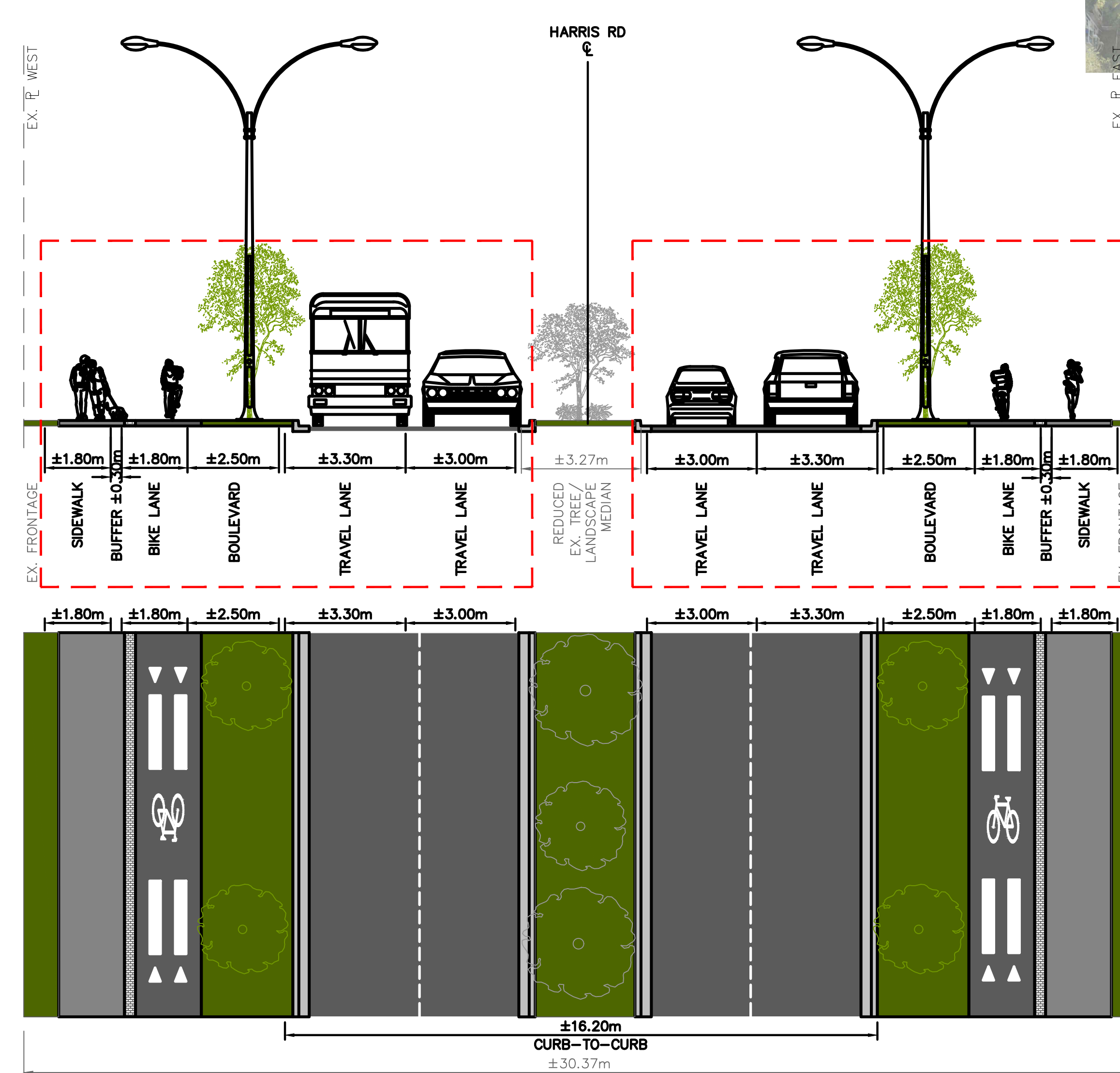
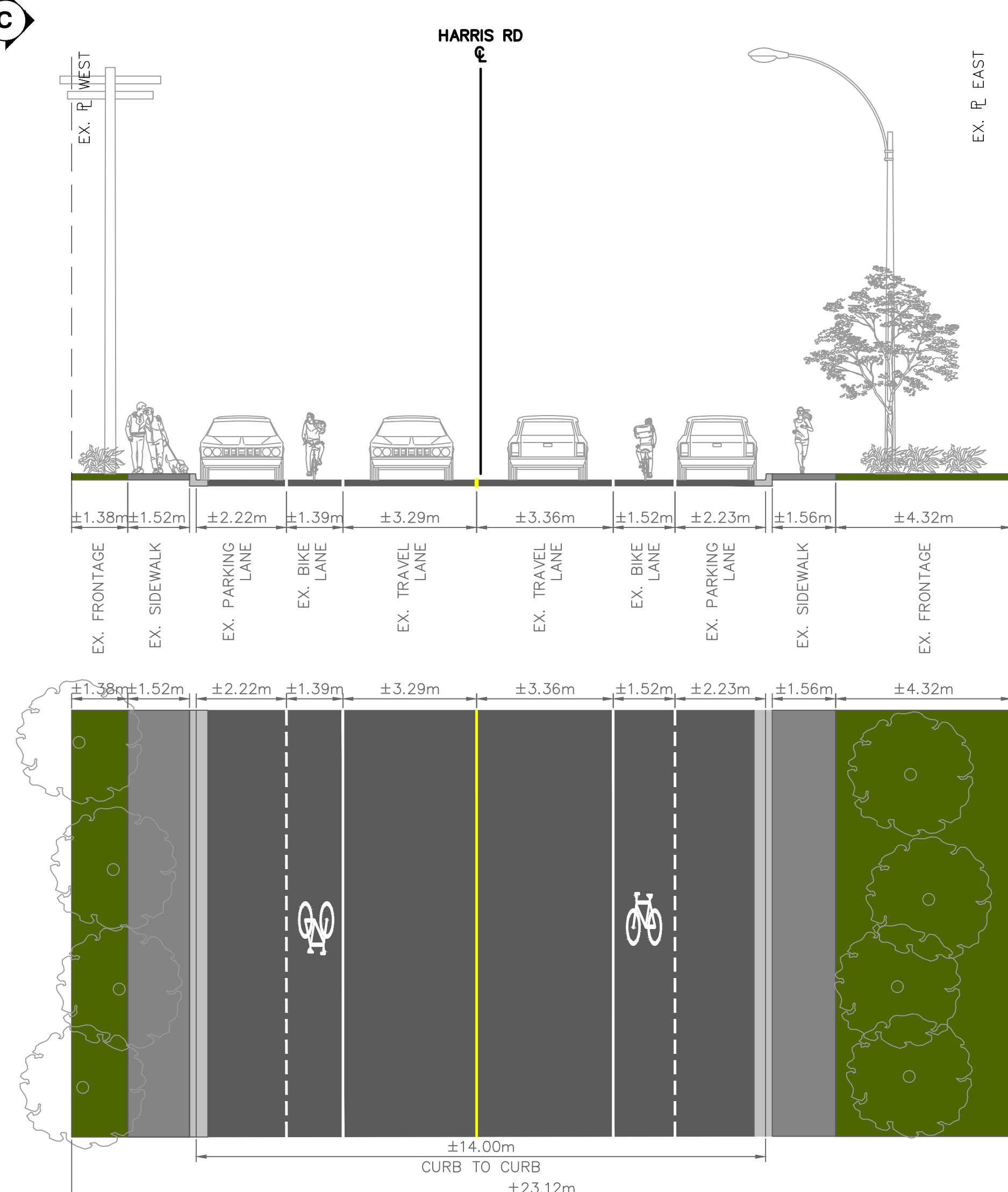
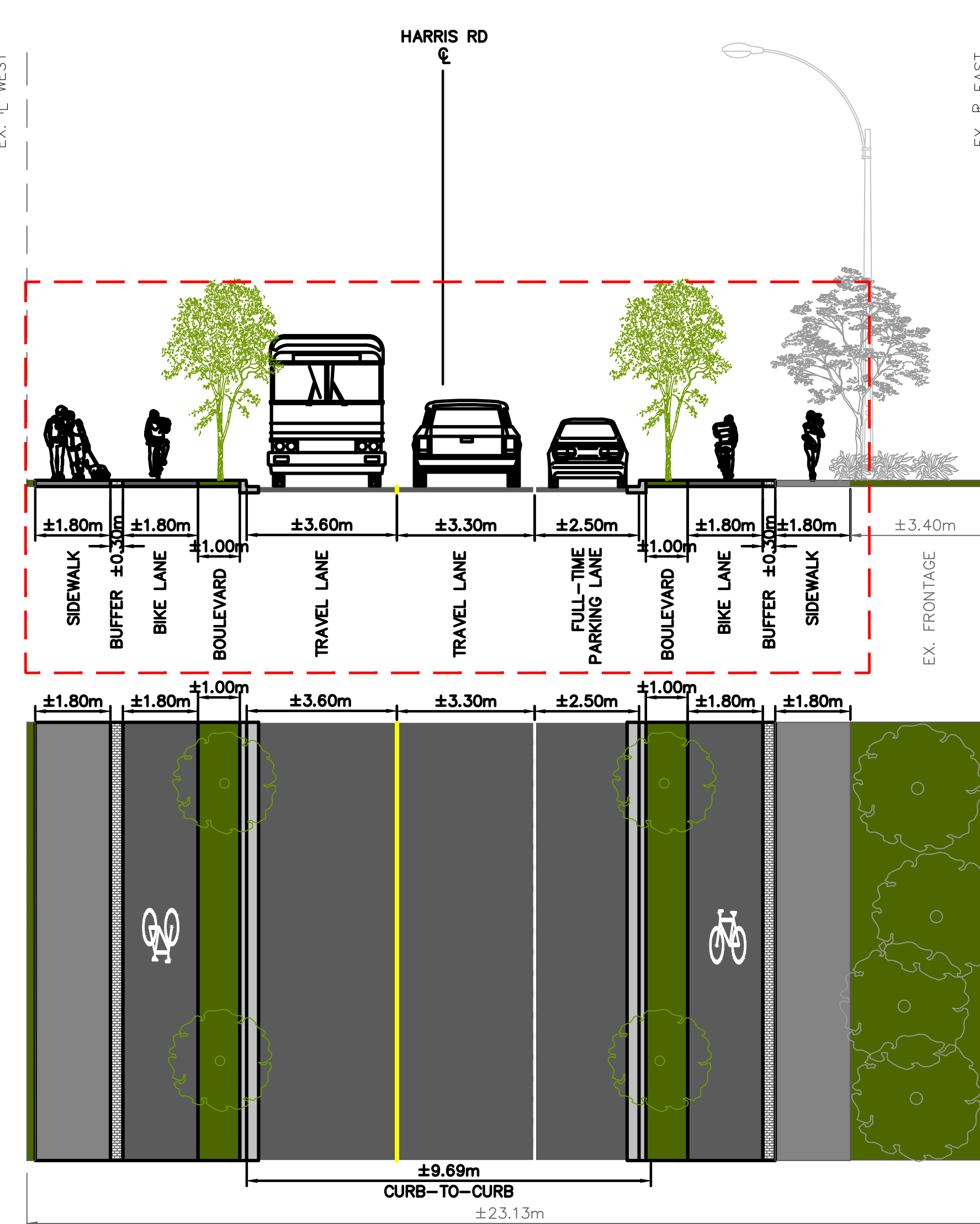






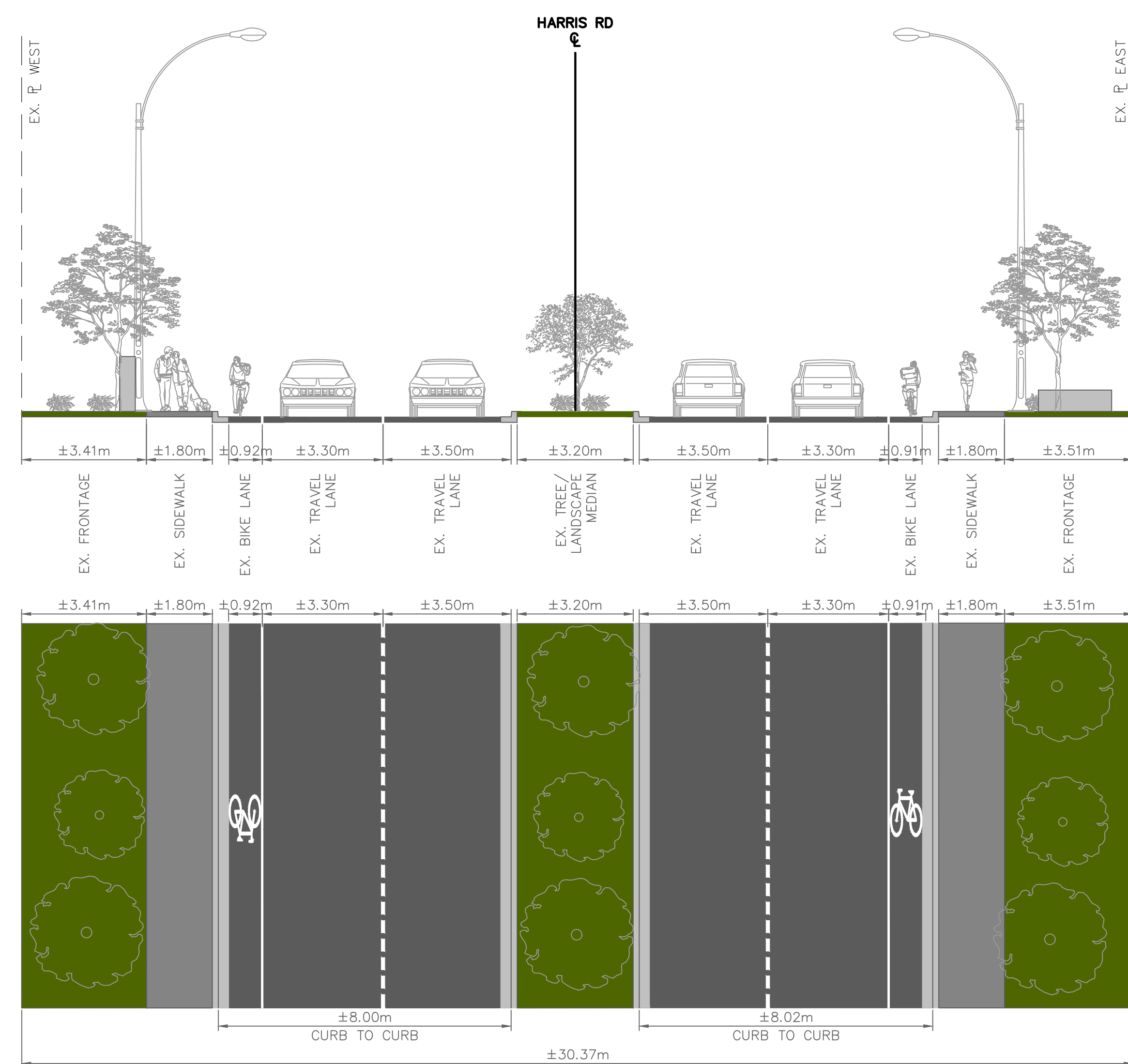

**LEGEND**

- CONCRETE SIDEWALK
- ASPAHLT
- ASPAHLT MULTI-USE PATHWAY
- LANDSCAPING / GRASS
- DRIVEWAY
- EXISTING STREETLIGHT
- PROPOSED STREETLIGHT
- TRAFFIC SIGNAL
- EXISTING UTILITY BOX / POLE AND TRAFFIC POLE TO BE RELOCATED
- EXISTING TREE REMOVAL
- PROPOSED TREE
- FUTURE TRANSIT STOP
- EXISTING TRANSIT STOP
- PROPOSED DESIGN AREA





**EXISTING HARRIS ROAD SEGMENT 7 (124 AVE TO LOUGHEED HIGHWAY)**  
**TYPICAL CROSS SECTION F**

-  EXISTING UTILITY BOX / POLE AND TRAFFIC POLE TO BE RELOCATED
-  EXISTING TREE REMOVAL
-  PROPOSED TREE
-  FUTURE TRANSIT STOP
-  EXISTING TRANSIT STOP
-  PROPOSED DESIGN AREA